

Pk=575
PlP=57
R=300
T=7.89

Pk=545.98; Rze=54.52
PlP=534.04; KlP=557.97
R=300.00
max Pk=557.26; Rze=54.49
T=11.98; B=0.24

Pk=519.97; Rze=52.50
PlP=510.48; KlP=529.44
R=50.00
min Pk=517.83; Rze=52.79
T=9.50; B=0.30

Pk=483.66; Rze=54.97
PlP=460.73; KlP=478.58
R=500.00
T=8.93; B=0.08

Pk=487.73; Rze=55.65
PlP=396.56; KlP=440.95
R=500.00
max Pk=420.91; Rze=55.49
T=22.20; B=0.16

Pk=364.56; Rze=54.77
PlP=354.96; KlP=374.27
R=1000.00
T=9.71; B=0.05

Pk=282.69; Rze=51.85
PlP=274.92; KlP=290.46
R=200.00
min Pk=283.33; Rze=52.00
T=7.78; B=0.5

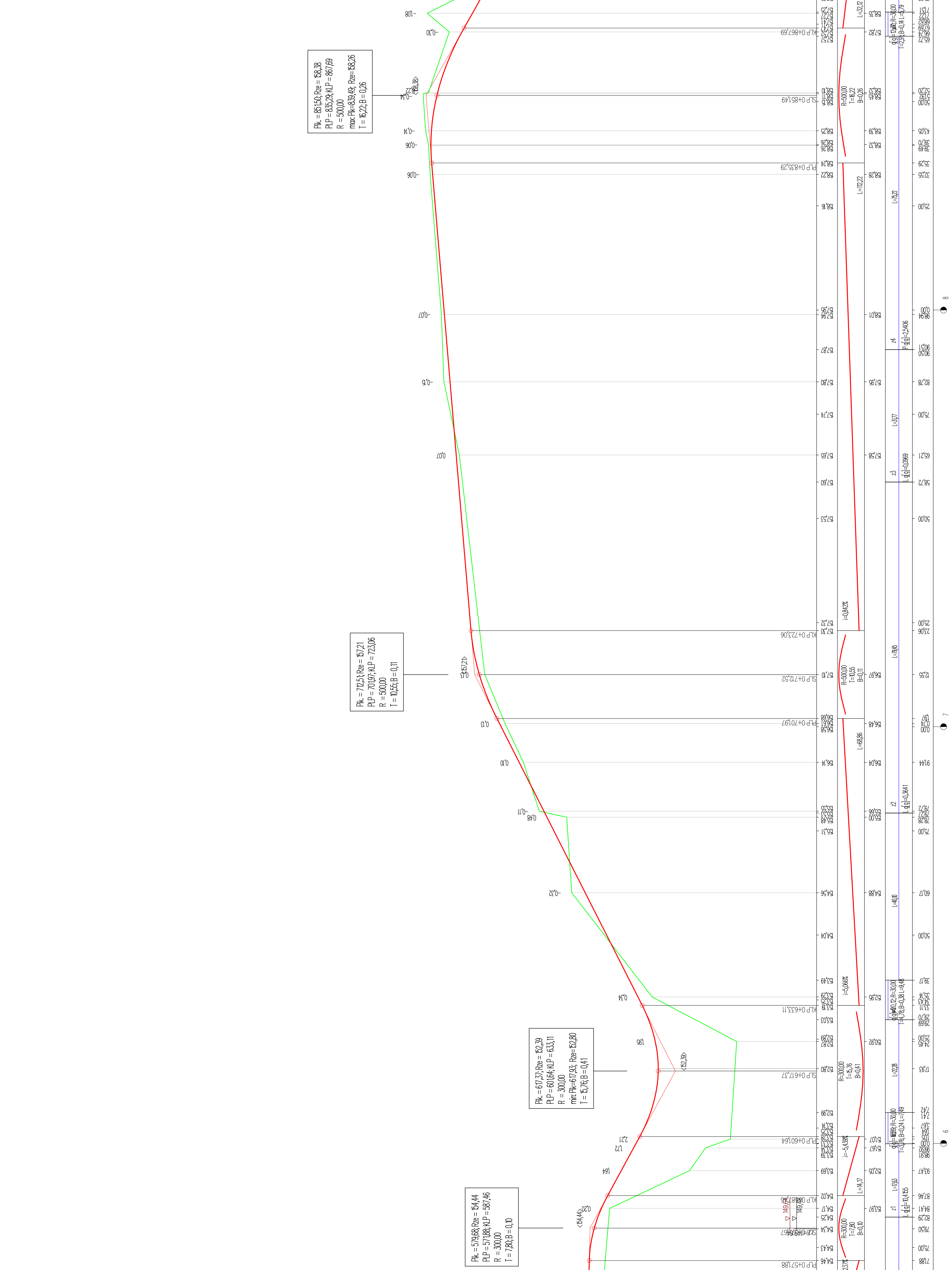

$Pk = 85150; Rze = 168,38$
 $PLP = 83523; KLP = 867,69$
 $R = 500,00$
 $max Pk = 839,49; Rze = 168,26$
 $T = 16,22; B = 0,26$

$Pk = 7251; Rze = 157,21$
 $PLP = 70197; KLP = 723,06$
 $R = 500,00$
 $T = 10,55; B = 0,11$

$Pk = 617,37; Rze = 152,39$
 $PLP = 60164; KLP = 633,11$
 $R = 300,00$
 $min Pk = 617,83; Rze = 152,80$
 $T = 15,76; B = 0,41$

$Pk = 579,68; Rze = 154,44$
 $PLP = 571,88; KLP = 587,46$
 $R = 300,00$
 $T = 7,80; B = 0,10$

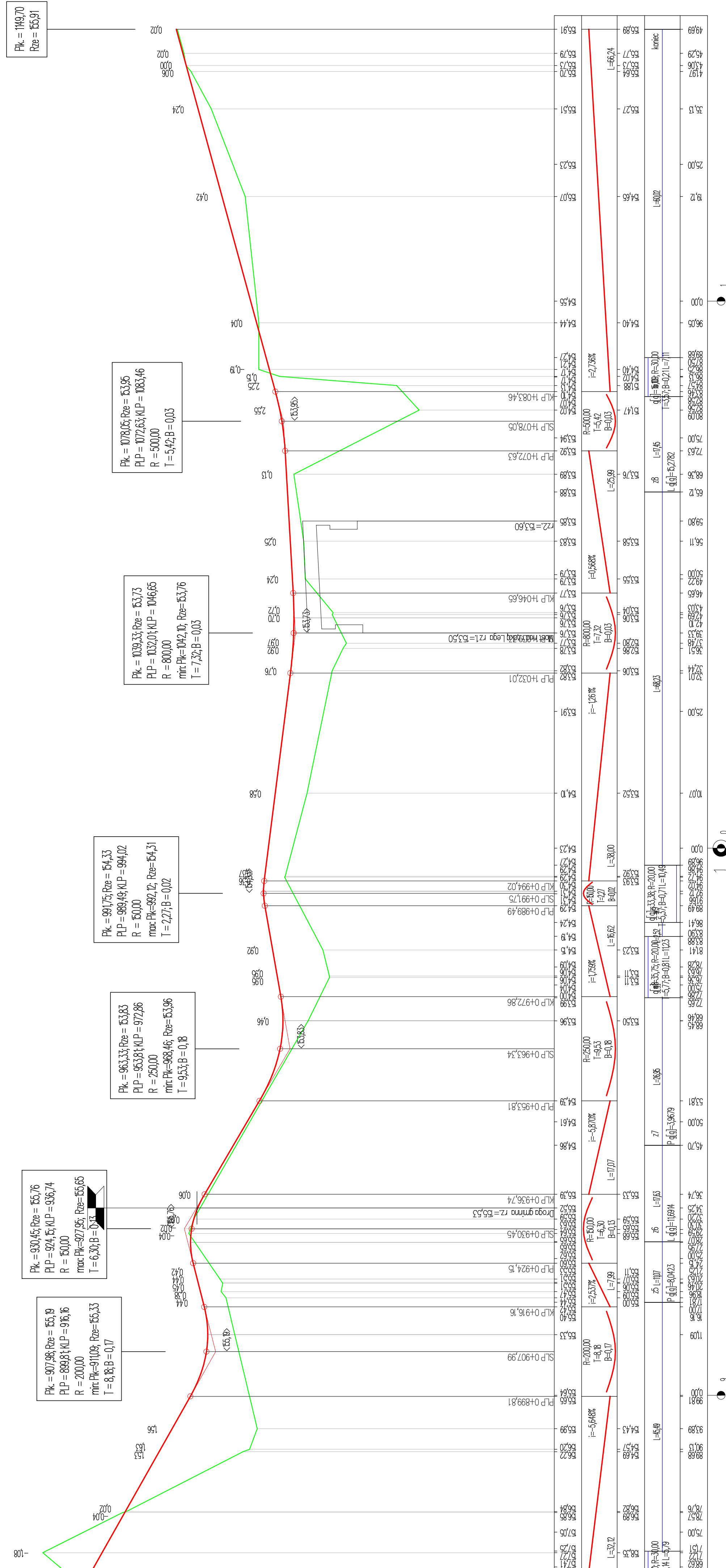

Pk. = 149,70
Rze = 55,91

Pk. = 1078,05; Rze = 53,95
PIP = 1072,63; KLP = 1083,46
R = 500,00
T = 5,42; B = 0,03

Pk. = 1039,33; Rze = 53,73
PIP = 1032,01; KLP = 1046,65
R = 800,00
min: Pk=1042,10; Rze=53,76
T = 7,32; B = 0,03

Pk. = 991,75; Rze = 54,33
PIP = 989,49; KLP = 994,02
R = 50,00
max: Pk=992,12; Rze=54,31
T = 2,27; B = 0,02

Pk. = 963,33; Rze = 53,83
PIP = 953,81; KLP = 972,86
R = 250,00
min: Pk=968,46; Rze=53,96
T = 9,53; B = 0,18

Pk. = 930,45; Rze = 55,76
PIP = 924,55; KLP = 936,74
R = 150,00
max: Pk=927,95; Rze=55,65
T = 6,30; B = 0,13

Pk. = 907,98; Rze = 55,19
PIP = 899,81; KLP = 916,16
R = 200,00
min: Pk=911,09; Rze=55,33
T = 8,18; B = 0,17

